

CERTIFIED RECORD OF LAND CORNER MONUMENTATION

History of original corner establishment:

The original corner was established by Henry W. Cooke in 1883.

Set basalt stone 16x12x7 ins. 10 ins in the ground for cor to secs 4,5,32 &33. marked with 4 notches on the E. and 2 notches on the West edges. dug pits in each sec 5½ ft dist and raised a mound of earth 2 ft high 4½ ft base alongside.

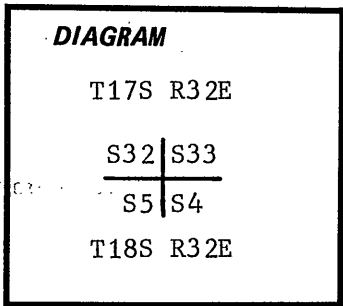

Description of corner evidence found:

Found a 19x11x7 stone, firmly set, with 2 grooves on the West face and 4 grooves on the East face, in a mound of stone.

Description of monument and accessories established to perpetuate the original location of this corner:

Set a 3¼" x 30" USDA aluminum monument with magnet 22" in the ground in a mound of stone. Placed the original stone in the mound.

CAP MARKED

15" Ponderosa Pine bears N 50½ E, 206.8 feet scribed T17SR32E S33BT, with a 3/4" brass washer attached between the B & T. Painted face and band red on the BT and attached Attention sign and BT tag. Measured to the center of the BT.

T17S R32E
S32 | S33
S5 | S4
T18S
PLS 1918
1985

Set a 2" aluminum cap on rebar S 45 E, 25.0 feet stamped

T18S R32E S4 RM N45W 25.0 PLS 1918 1985.

Set a 2" aluminum cap on rebar S 45 W, 25.0 feet stamped

T18S R32E S5 RM N45E 25.0 PLS 1918 1985.

Set a 2" aluminum cap on rebar N 45 W, 25.0 feet stamped

T17S R32E S32 RM S45E 25.0 PLS 1918 1985.

Set a steel fence post with Attention sign West 3 feet.

Work performed 18 May 1985

Witness: Louise H. Parsons

Tyler B. Parsons, PLS 1918
1915 SE Stone Street
Corvallis, OR 97333
(503) 752-7515

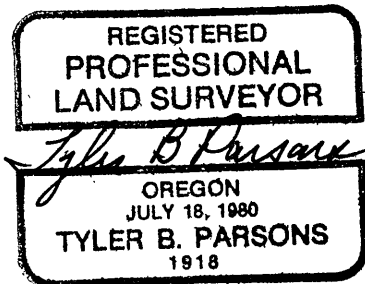

Road Cadastral Survey, Cont No 53-04H1-4-9665N

Office of... Sauwage ... County of... Grant ...
 State of... Oregon ... I hereby certify that the within instrument was filed in this office
 for record on the... 19 day of... June ... 1985
Robert D. Begett by _____
 (COUNTY OFFICIAL) (DEPUTY)